

ASBUILT SURVEY FOR:
ORANGEWOOD N-2 PD - PARCELS 6A & 6 B
OUTPARCELS 5 & 6 - DOLPHIN PLAZA
S. INTERNATIONAL DRIVE
ORANGE COUNTY, FLORIDA
PARCEL 10#13-24-28-6283-00-061
SEC13 T2N24S R10E28E

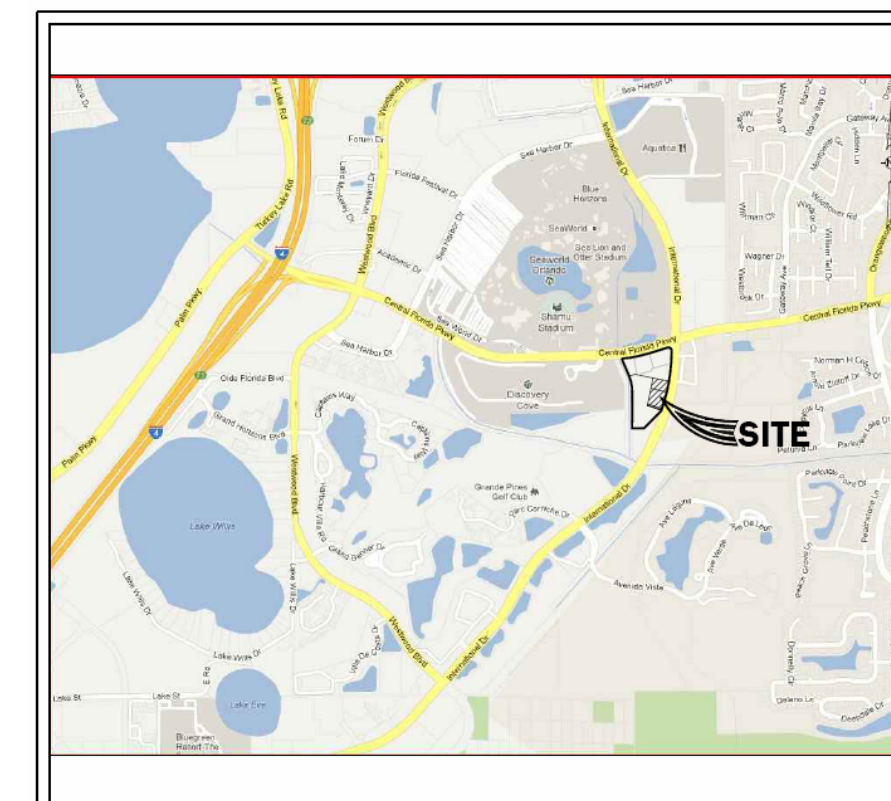

SITE VICINITY MAP
N.T.S.

SCALE 1"=20'
0 20 40

| LEGEND | |
|--------|---------------------|
| | CONTROL POINT |
| | GATE VALVE |
| | DDCVA |
| | BFRPZ |
| | 45 BEND |
| | 90 BEND |
| | SANITARY MANHOLE |
| | FIRE HYDRANT |
| | SANITARY CLEAN OUT |
| | TEE |
| | STORM MANHOLE |
| | ROOF DRAIN CLEANOUT |
| | STORM INLET |
| | FDC |

REQUIRED SETBACKS
FRONT (INTL DRIVE) 50'
SIDE (NORTH) 0'
SIDE (SOUTH) 0'
SIDE (WEST) 0'

| | |
|--------|----------------------------------|
| PSM | PROFESSIONAL SURVEYOR AND MAPPER |
| D.U.E. | DRAINAGE AND UTILITY EASEMENT |
| D.E. | DRAINAGE EASEMENT |
| U.E. | UTILITY EASEMENT |
| P.B. | PLAT BOOK |
| O.R.B. | OFFICIAL RECORDS BOOK |
| LB | LICENSED BUSINESS |
| PRM | PERMANENT REFERENCE MONUMENT |
| PCP | PERMANENT CONTROL POINT |
| D.I.P. | DUCTILE IRON PIPE |
| W | WATERMAIN |
| WM | WATERMAIN |
| TYP | TYPICAL |
| OU | OVERHEAD UTILITY LINE |
| LP | LIGHTPOLE |
| P.O.C. | POINT OF COMMENCEMENT |
| P.O.B. | POINT OF BEGINNING |
| FND | FOUND |
| IR | IRON ROD AND CAP |
| CR | CONCRETE BLOCK STRUCTURE |
| PTV | POST INDICATOR VALVE |
| FM | FORCEMAIN |
| GV | GATE VALVE |
| HDPE | HIGH DENSITY POLYETHYLENE |
| PVC | POLYVINYL CHLORIDE |
| RCP | REINFORCED CONCRETE PIPE |
| C/L | CENTERLINE |
| ARV | AIR RELEASE VALVE |
| CS | CORPORATION STOP |

SURVEYORS NOTES

1. THE SURVEYOR HAS NOT ABSTRACTED THE LAND SHOWN HEREON FOR EASEMENTS, RIGHT OF WAY, OR RESTRICTIONS OF RECORD WHICH MAY EFFECT THE TITLE OR USE OF THE LAND.
2. THERE MAY BE ADDITIONAL EASEMENTS AND RESTRICTIONS THAT ARE NOT SHOWN ON THIS SURVEY, BUT MAY BE FOUND IN THE PUBLIC RECORDS OF THIS COUNTY.
3. NO UNDERGROUND OR ABOVE GROUND IMPROVEMENTS OR UTILITIES HAVE BEEN LOCATED EXCEPT AS SHOWN.
4. NO F.E.M.A. FLOOD ELEVATIONS RESEARCHED BY THIS SURVEYOR.
5. THE SURVEY SHOWN HEREON IS BASED ON A BOUNDARY & TOPOGRAPHICAL SURVEY PROVIDED BY CLIENT.
6. ELEVATIONS SHOWN HEREON ARE BASED ON TOPOGRAPHICAL SURVEY PROVIDED BY CLIENT WITH BASIS OF DATUM NGVD(83) - JGD40(15) IS NORTHING/EASTING COORDINATES ARE BASED UPON FLORIDA STATE PLANE EAST ZONE, NAD83-1990 ADJUSTMENT.
7. UNLESS SIGNED AND EMBOSSED WITH SURVEYORS SEAL, THIS SURVEY IS NOT VALID AND IS PRESENTED FOR INFORMATIONAL PURPOSES ONLY.
8. ADDITIONS OR DELETIONS TO THIS AS-BUILT BY OTHER THAN THE SIGNING PARTY IS PROHIBITED WITHOUT THE WRITTEN CONSENT OF THE SIGNING PARTY.
9. THE UNDERGROUND UTILITIES SHOWN HEREON HAVE BEEN EITHER PHYSICALLY LOCATED BY FIELD SURVEY METHODS OR SHOWN BY INFORMATION AND DRAWINGS PROVIDED BY CLIENT. THE SURVEYOR MAKES NO GUARANTEE THAT THE UNDERGROUND UTILITIES SHOWN HEREON COMPRISE ALL SUCH UTILITIES IN THE AREA, EITHER IN SERVICE OR ABANDONED. HE DOES CERTIFY THAT THEY ARE SHOWN AS ACCURATELY AS POSSIBLE FROM INFORMATION AVAILABLE AND ABOVE GROUND OBSERVABLE EVIDENCE OF SAID UTILITIES.
10. RIGHT OF WAY LINES SHOWN HEREON ARE BASED UPON INFORMATION SUPPLIED TO THIS FIRM AND RECOVERED MONUMENTATION AS SHOWN.
11. THIS SURVEY DOES NOT REFLECT A FINAL AS-BUILT OF ENTIRE SITE, AS SPECIFICALLY DIRECTED BY CLIENT.
12. FOR LEGAL DESCRIPTION, SEE JOB# 0915.15

KOVACS CONSTRUCTION SERVICES, INC.
4500 SHELDON AVE. SUITE 201
ORLANDO, FL 32817
(407) 887-4041 Phone
(407) 887-4031 Fax

NOT VALID WITHOUT THE ORIGINAL RAISED SEAL AND SIGNATURE OF A FLORIDA LICENSED SURVEYOR

JAMES K. KERN P.S.M. #5899

ORANGEWOOD N-2 PD - PARCELS 6A & 6 B
OUTPARCELS 5 & 6 - DOLPHIN PLAZA
S. INTERNATIONAL DRIVE
ORANGE COUNTY, FLORIDA
PARCEL 10#13-24-28-6283-00-061
SEC13 T2N24S R10E28E

ASBUILT SURVEY

CLIENT:
ORLANDO CONSTRUCTION, LLC
4500 SHELDON AVE. SUITE 201
ORLANDO, FL 32817
(407) 887-4041 Phone
(407) 887-4031 Fax

DRAWING
DOLPHINASBSPV

SHEET 1
OF 2

ASBUILT SURVEY FOR:
ORANGEWOOD N-2 PD - PARCELS 6A & 6 B
OUTPARCELS 5 & 6 - DOLPHIN PLAZA
S. INTERNATIONAL DRIVE
ORANGE COUNTY, FLORIDA
PARCEL 10#13-24-28-6283-00-061
SEC13 T2N24S R4G28E

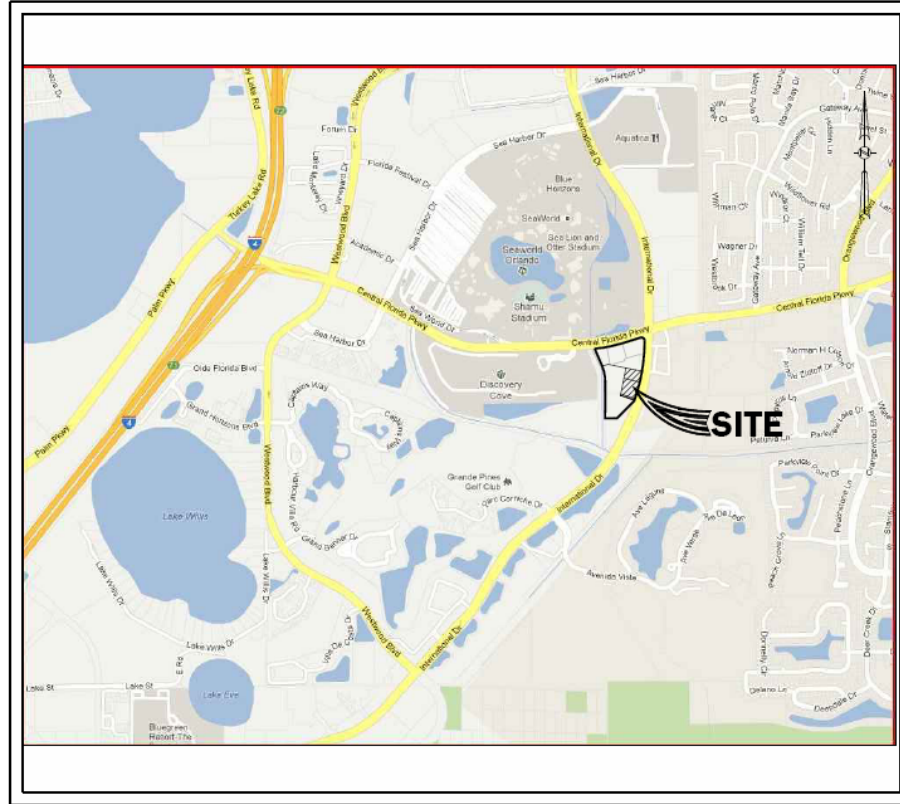

SITE VICINITY MAP
N.T.S

| WATER/FIRELINE ASBUILT TABLE | | | | | | | | | |
|---------------------------------------------------------------------------|-------------------------------------------------------------------------|------------------------------------------------------------------------------|--------------------------------------------------------------------------|------------------------------------------------------------------------------|--|--|--|--|--|
| WM1 4" WM TSV N: 1479886.3381 E: 509492.2591 EL: 77.63 | FL1 6" FL CONNECT N: 1480047.8790 E: 509543.7351 EL: 83.47 | FL7 6" FL 45° BEND N: 1480109.1176 E: 509607.0653 EL: 81.14 | FL13 8" FL 90° BEND N: 1480053.7286 E: 509603.4812 EL: 81.61 | FL19 PIV N: 1480104.1011 E: 509616.6394 EL: 88.62 | | | | | |
| WM2 4" X2" WM SADDLE N: 1479872.6799 E: 509492.3810 EL: 75.81 | FL2 6" FL 45° BEND N: 1480072.6176 E: 509544.7033 EL: 83.04 | FL8 PIV N: 1480106.0051 E: 509607.2893 EL: 87.53 | FL14 8" FL 45° BEND N: 1480107.9240 E: 509603.3375 EL: 82.14 | FL20 10" X8" FL REDUCER N: 1480098.6545 E: 509617.2473 EL: 80.79 | | | | | |
| WM3 2" WM MTR N: 1479872.7511 E: 509489.9521 EL: 84.62 | FL3 6" FL 45° BEND N: 1480075.3076 E: 509544.6207 EL: 80.98 | FL9 PIV N: 1480102.9677 E: 509607.6168 EL: 89.08 | FL15 8" FL 45° BEND N: 1480113.6721 E: 509609.4420 EL: 82.19 | FL21 10" FL GV N: 1480096.0889 E: 509617.2044 EL: 82.53 | | | | | |
| WM4 2" WM BFP N: 1479879.6140 E: 509491.8422 EL: 84.72 | FL4 6" FL 45° BEND N: 1480085.9988 E: 509545.0539 EL: 81.74 | FL10 10" X6" FL REDUCER N: 1480095.1753 E: 509607.6426 EL: 80.07 | FL16 8" FL 45° BEND N: 1480111.6010 E: 509614.3158 EL: 81.98 | WM7 2" WM POLY STUB N: 1479891.8690 E: 509622.7659 EL: 80.75 | | | | | |
| WM5 1.5" WM MTR N: 1479873.0442 E: 509496.0088 EL: 84.45 | FL5 6" FL 45° BEND N: 1480106.6536 E: 509567.5873 EL: 85.45 | FL11 10" FL GV N: 1480095.1753 E: 509607.6426 EL: 81.95 | FL17 8" FL 45° BEND N: 1480111.6010 E: 509614.3158 EL: 80.75 | WM8 2" WM POLY STUB N: 1479895.7012 E: 509622.5955 EL: 80.75 | | | | | |
| WM6 1.5" WM BFP N: 1479879.4477 E: 509495.2654 EL: 84.22 | FL6 6" FL 45° BEND N: 1480109.2152 E: 509605.7291 EL: 81.91 | FL12 4" FL RISER N: 1480082.9656 E: 509609.5078 EL: 86.70 | FL18 8" FL 45° BEND N: 1480107.1673 E: 509615.4673 EL: 87.24 | | | | | | |

| STORM ASBUILT TABLE | | | | | | | | | |
|--------------------------------------------------------------------------------------------------------------------------------------|--------------------------------------------------------------------------------------------------------------------------------------|-------------------------------------------------------------------------------------------------------------------------------------|--------------------------------------------------------------------------------------------------------------------------------------|------------------------------------------------------------------------|-----------------------------------------------------------------------------------------|----------------------------------------------------------------------------------------------------------|-----------------------------------------------------------------------------------------|------------------------------------------------------------------------|-----------------------------------------------------------------------------------------|
| EX-D17 STORM INLET N: 1480092.8450 E: 509598.5589 TOP: 85.61 S. INV: 81.24 EX W. INV: 81.24 EX NE. INV: 82.19 | SD-2 STORM INLET N: 1479926.5404 E: 509600.9345 TOP: 85.65 S. INV: 83.00 NE. INV: 83.00 | RDC-2 ROOF DRAIN N: 1480045.0326 E: 509446.1596 INV: 82.45 | SD-3 ROOF DRAIN C/O N: 1480051.0765 E: 509491.1067 TOP: 85.73 INV: 81.90 | RDC-4 ROOF DRAIN N: 1480044.9702 E: 509506.2693 INV: 82.13 | SD-5 ROOF DRAIN C/O N: 1480051.0954 E: 509414.7077 TOP: 86.25 INV: 82.80 | RDC-5 ROOF DRAIN N: 1480045.0632 E: 509536.2862 INV: 82.31 | SD-6 ROOF DRAIN C/O N: 1480050.9579 E: 509577.2087 TOP: 85.86 INV: 82.37 | RDC-6 ROOF DRAIN N: 1480046.1372 E: 509563.4118 INV: 82.44 | SD-7 ROOF DRAIN C/O N: 1479991.9207 E: 509572.4032 TOP: 85.82 INV: 82.83 |
| EX-D19 STORM INLET N: 1480084.2471 E: 509514.1655 TOP: 84.75 N. INV: 81.39 EX S. INV: 81.39 EX E. INV: 81.39 EX | EX-D21 STORM INLET N: 1480073.9680 E: 509483.1888 TOP: 85.93 N. INV: 81.68 EX S. INV: 81.68 EX E. INV: 81.68 EX | EX-D23 STORM INLET N: 1480062.3480 E: 509562.291 TOP: 84.69 N. INV: 82.09 EX S. INV: 82.09 EX E. INV: 82.09 EX | EX-D24 STORM INLET N: 1479870.7242 E: 509315.8154 TOP: 83.06 N. INV: 82.48 EX S. INV: 82.48 EX E. INV: 82.48 EX | RDC-1 ROOF DRAIN N: 1480044.9145 E: 509416.2850 INV: 82.90 | RDC-3 ROOF DRAIN N: 1480044.6801 E: 509476.2245 INV: 82.17 | SD-1 STORM INLET N: 1479923.4178 E: 509489.7722 TOP: 85.46 S. INV: 82.88 W. INV: 82.88 | | | |

| SANITARY SEWER ASBUILT TABLE | | | | | | | | | |
|-------------------------------------------------------------------------------------------------------------------------------------|-----------------------------------------------------------------------------------------|-------------------------------------------------------------------------------------------------|-------------------------------------------------------------------------------------------------|-------------------------------------------------------------------------------------------------|-------------------------------------------------------------------------------------------------|----------------------------------------------------------------------------------------------------------------------------|-----------------------------------------------------------------------------------------|-------------------------------------------------------------------------------------------------|------------------------------------------------------------------------------------------|
| EX-S8 SANITARY MH N: 1480109.0446 E: 509684.8059 TOP: 85.80 N. INV: 77.65 EX S. INV: 77.65 EX E. INV: 77.67 | SSS-1 SANITARY C/O N: 1480048.1693 E: 509406.3708 TOP: 85.81 INV: 78.95 | GT-1 (NORTH) GREASE TRAP MH N: 1480055.5671 E: 509440.5894 TOP: 85.02 INV: 78.95 | GT-5 (WEST) GREASE TRAP MH N: 1480052.9495 E: 509739.0065 TOP: 86.75 INV: 79.12 | GT-6 (EAST) GREASE TRAP MH N: 1480048.6752 E: 509739.3640 TOP: 86.77 INV: 79.24 | GT-3 GREASE TRAP N: 1480048.7190 E: 509420.3264 TOP: 87.40 INV: 82.75 | EX-S7 SANITARY MH N: 1480094.9773 E: 509466.7438 TOP: 85.21 N. INV: 75.68 S. INV: 75.68 E. INV: 77.06 | SSS-2 SANITARY C/O N: 1480049.8710 E: 509453.3427 TOP: 87.38 INV: 78.99 | GT-2 (SOUTH) GREASE TRAP MH N: 1480055.4683 E: 509436.3054 TOP: 85.99 INV: 80.10 | SSS-3 SANITARY C/O N: 1480049.3025 E: 509493.2480 TOP: 87.39 INV: 79.10 |
| EX-S9 SANITARY MH N: 1480080.1543 E: 509339.3076 TOP: 85.13 N. INV: 75.67 EX S. INV: 75.67 EX E. INV: 75.67 EX | SSS-4 SANITARY C/O N: 1480048.0790 E: 509514.0637 TOP: 86.70 INV: 78.85 | GT-2 (SOUTH) GREASE TRAP MH N: 1480055.2188 E: 509445.7286 TOP: 86.07 INV: 79.90 | GT-3 (NORTH) GREASE TRAP MH N: 1480050.5725 E: 509551.9065 TOP: 86.23 INV: 79.30 | GT-4 (SOUTH) GREASE TRAP MH N: 1480050.4062 E: 509547.7842 TOP: 86.27 INV: 79.18 | GT-5 (NORTH) GREASE TRAP MH N: 1480050.5726 E: 509561.5406 TOP: 86.05 INV: 79.57 | SSS-5 SANITARY C/O N: 1480048.8950 E: 509556.5210 TOP: 86.86 INV: 79.12 | SSS-6 SANITARY C/O N: 1480048.3792 E: 509564.5305 TOP: 87.78 INV: 79.93 | SSS-7 SANITARY C/O N: 1480051.6513 E: 509505.3837 TOP: 87.48 INV: 79.52 | SSS-8 SANITARY C/O N: 1480071.7917 E: 509587.6166 TOP: 85.73 INV: 78.66 |
| SSCO-1 SANITARY C/O N: 1480051.6513 E: 509505.3837 TOP: 87.48 INV: 79.52 | SSCO-2 SANITARY C/O N: 1480051.6513 E: 509505.3837 TOP: 87.48 INV: 79.52 | SSCO-3 SANITARY C/O N: 1480071.7917 E: 509587.6166 TOP: 85.73 INV: 78.66 | SSCO-4 SANITARY C/O N: 1480051.6513 E: 509505.3837 TOP: 87.48 INV: 79.52 | SSCO-5 SANITARY C/O N: 1480051.6513 E: 509505.3837 TOP: 87.48 INV: 79.52 | SSCO-6 SANITARY C/O N: 1480051.6513 E: 509505.3837 TOP: 87.48 INV: 79.52 | SSCO-7 SANITARY C/O N: 1480051.6513 E: 509505.3837 TOP: 87.48 INV: 79.52 | SSCO-8 SANITARY C/O N: 1480051.6513 E: 509505.3837 TOP: 87.48 INV: 79.52 | SSCO-9 SANITARY C/O N: 1480051.6513 E: 509505.3837 TOP: 87.48 INV: 79.52 | SSCO-10 SANITARY C/O N: 1480051.6513 E: 509505.3837 TOP: 87.48 INV: 79.52 |

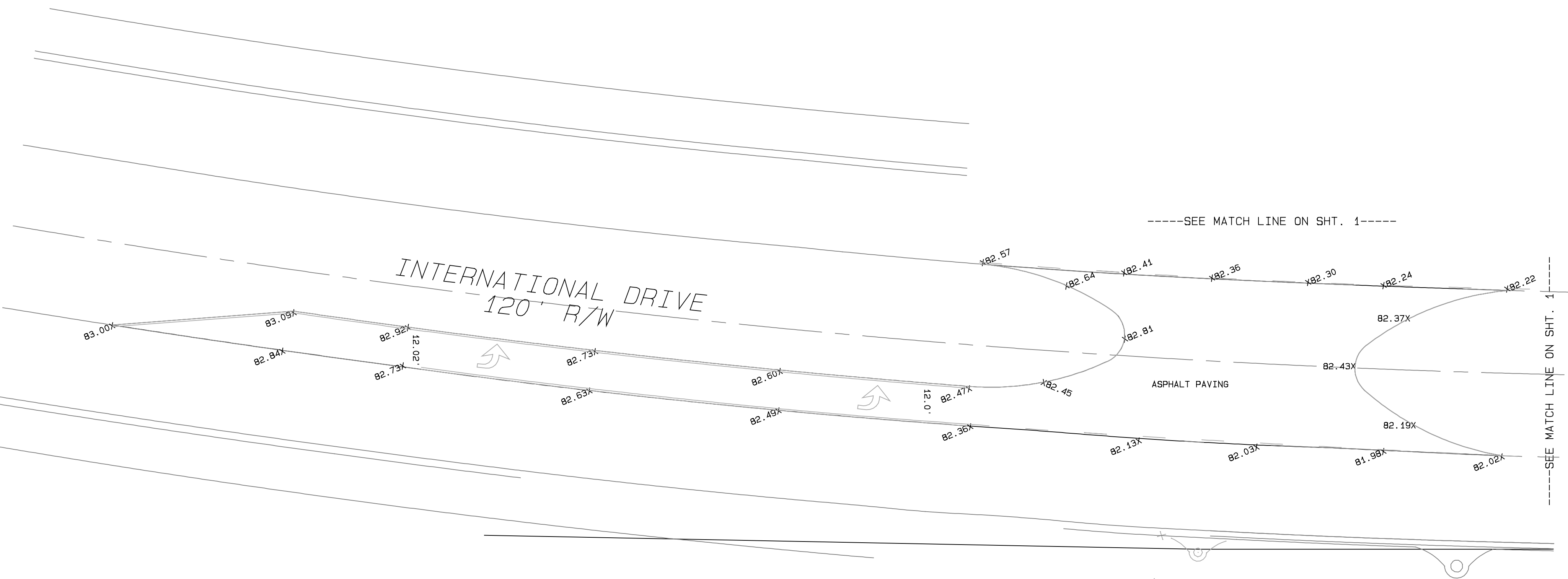

- SURVEYORS NOTES
1. THE SURVEYOR HAS NOT ABSTRACTED THE LAND SHOWN HEREON FOR EASEMENTS, RIGHT OF WAY, OR RESTRICTIONS OF RECORD WHICH MAY EFFECT THE TITLE OR USE OF THE LAND.
 2. THERE MAY BE ADDITIONAL EASEMENTS AND RESTRICTIONS THAT ARE NOT SHOWN ON THIS SURVEY, BUT MAY BE FOUND IN THE PUBLIC RECORDS OF THIS COUNTY.
 3. NO UNDERGROUND OR ABOVE GROUND IMPROVEMENTS OR UTILITIES HAVE BEEN LOCATED EXCEPT AS SHOWN.
 4. NO F.E.M.A. FLOOD ELEVATIONS RESEARCHED BY THIS SURVEYOR.
 5. THE SURVEY SHOWN HEREON IS BASED ON A BOUNDARY & TOPOGRAPHICAL SURVEY PROVIDED BY CLIENT, JOB#0915.15
 6. ELEVATIONS SHOWN HEREON ARE BASED ON TOPOGRAPHICAL SURVEY PROVIDED BY CLIENT WITH BASIS OF DATUM NGVD1929, JOB#0915.15
 7. NORTHING/EASTING COORDINATES ARE BASED UPON FLORIDA STATE PLANE EAST ZONE, NAD83-1980 ADJUSTMENT.
 8. UNLESS SIGNED AND EMBOSSED WITH SURVEYORS SEAL, THIS SURVEY IS NOT VALID AND IS PRESENTED FOR INFORMATIONAL PURPOSES ONLY.
 9. ADDITIONS OR DELETIONS TO THIS AS-BUILT BY OTHER THAN THE SIGNING PARTY IS PROHIBITED WITHOUT THE WRITTEN CONSENT OF THE SIGNING PARTY.
 10. THE UNDERGROUND UTILITIES SHOWN HEREON HAVE BEEN EITHER PHYSICALLY LOCATED BY FIELD SURVEY METHODS OR SHOWN BY INFORMATION AND DRAWINGS PROVIDED BY CLIENT. THE SURVEYOR MAKES NO GUARANTEE THAT THE UNDERGROUND UTILITIES SHOWN HEREON COMPRISE ALL SUCH UTILITIES IN THE AREA, EITHER IN SERVICE OR ABANDONED. HE DOES CERTIFY THAT THEY ARE SHOWN AS ACCURATELY AS POSSIBLE FROM INFORMATION AVAILABLE AND ABOVE GROUND OBSERVABLE EVIDENCE OF SAID UTILITIES.
 11. RIGHT OF WAY LINES SHOWN HEREON ARE BASED UPON INFORMATION SUPPLIED TO THIS FIRM AND RECOVERED MONUMENTATION AS SHOWN.
 12. THIS SURVEY DOES NOT REFLECT A FINAL AS-BUILT OF ENTIRE SITE, AS SPECIFICALLY DIRECTED BY CLIENT.
 13. FOR LEGAL DESCRIPTION, SEE JOB# 0915.15

KOVACS CONSTRUCTION SERVICES, INC.
4500 SHERIDAN AVE. PHONE: 321-863-7131
COCOA, FLORIDA 32926
CERTIFICATE OF AUTHORIZATION LB# 7823

NOT VALID WITHOUT THE ORIGINAL RAISED
SEAL AND SIGNATURE OF A FLORIDA LICENSED SURVEYOR

ORANGEWOOD N-2 PD - PARCELS 6A & 6 B
OUTPARCELS 5 & 6 - DOLPHIN PLAZA
S. INTERNATIONAL DRIVE
ORANGE COUNTY, FLORIDA
PARCEL 10#13-24-28-6283-00-061
SEC13 T2N24S R4G28E

ASBUILT SURVEY

CLIENT:
ORLANDO CONSTRUCTION, LLC
4500 SHERIDAN AVE. SUITE 201
ORLANDO, FL 32817
(407) 888-4041 Phone
(407) 887-4031 FAX

DRAWING
DOLPHINASBRSRV
SHEET 2
OF 2